

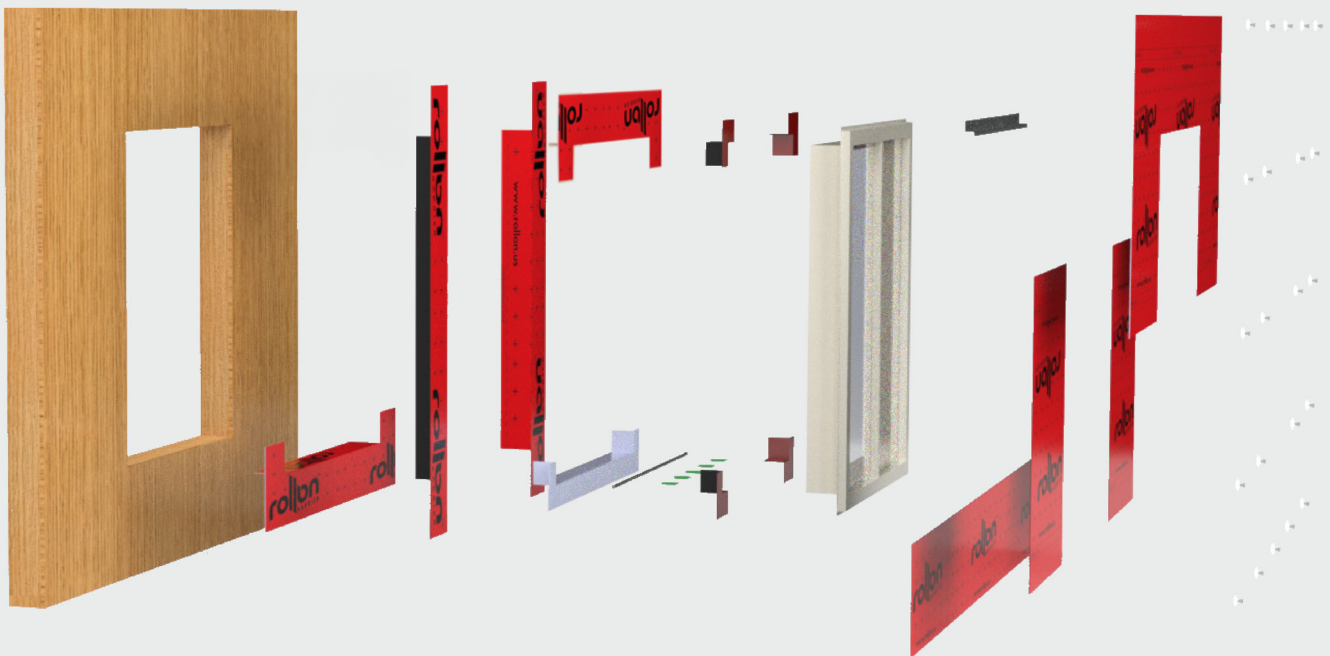

Mechanically Attached Membrane

WINDOW DETAILS -- Butyl Flashing Tape



STEP 1

Install **rollon**TM sill liner to sill of R.O. Leave bottom of liner loose to allow primary **rollon**TM to be inserted underneath.

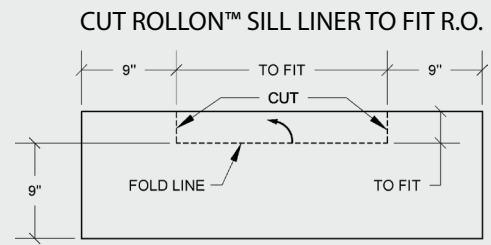

STEP 2

Apply **rollon**TM **corner** to sill jamb of R.O. over sill liner.

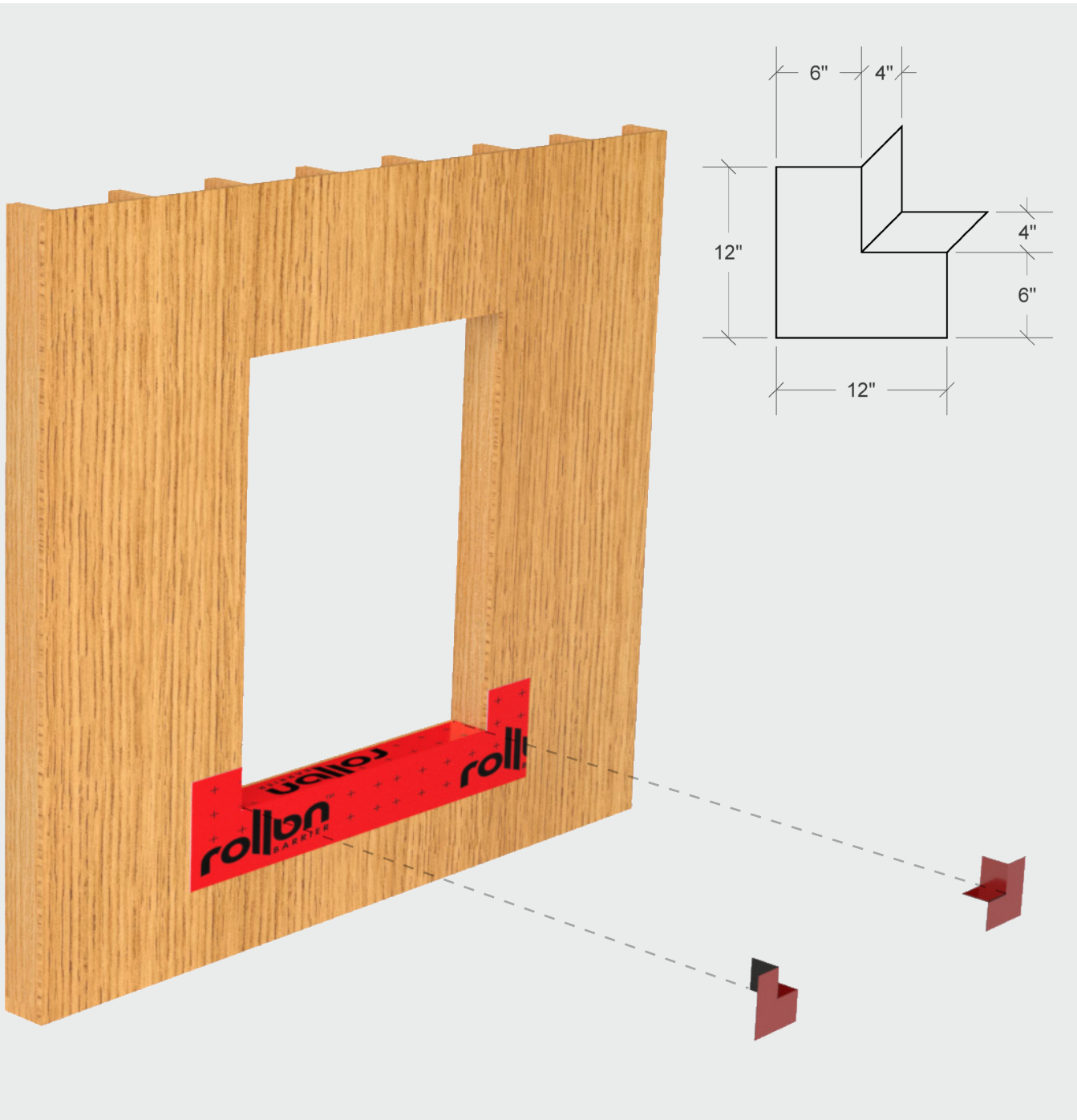

STEP 3

Install L-angle in R.O. embedded in Sealion LAF



STEP 4

Apply **Sealion**TM butyl tape flashing.
Apply **rollon**TM jamb liner to jamb of rough opening.

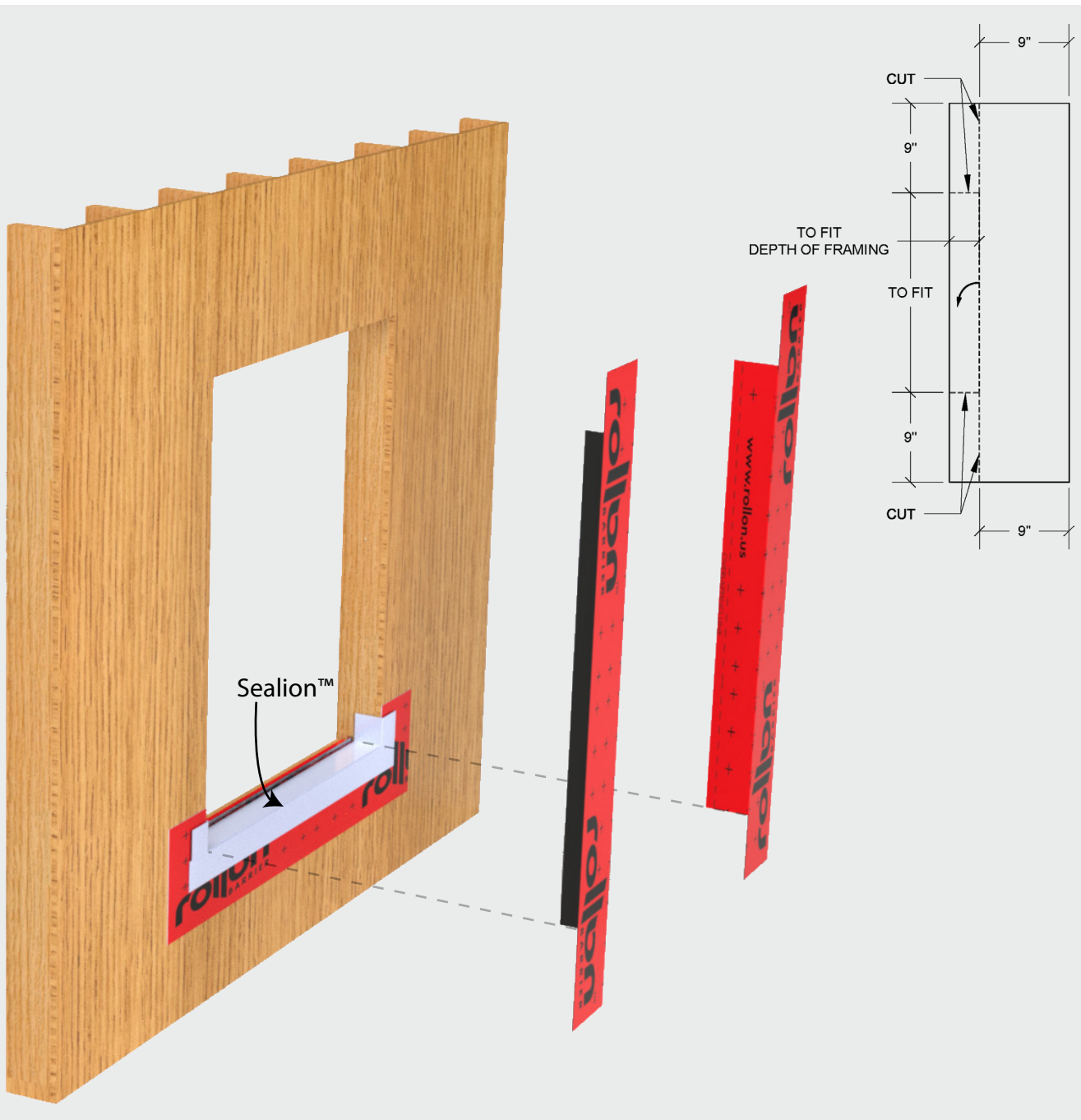

STEP 5

Apply **rollon**TM sill corner to sill jamb of R.O. over sill liner.

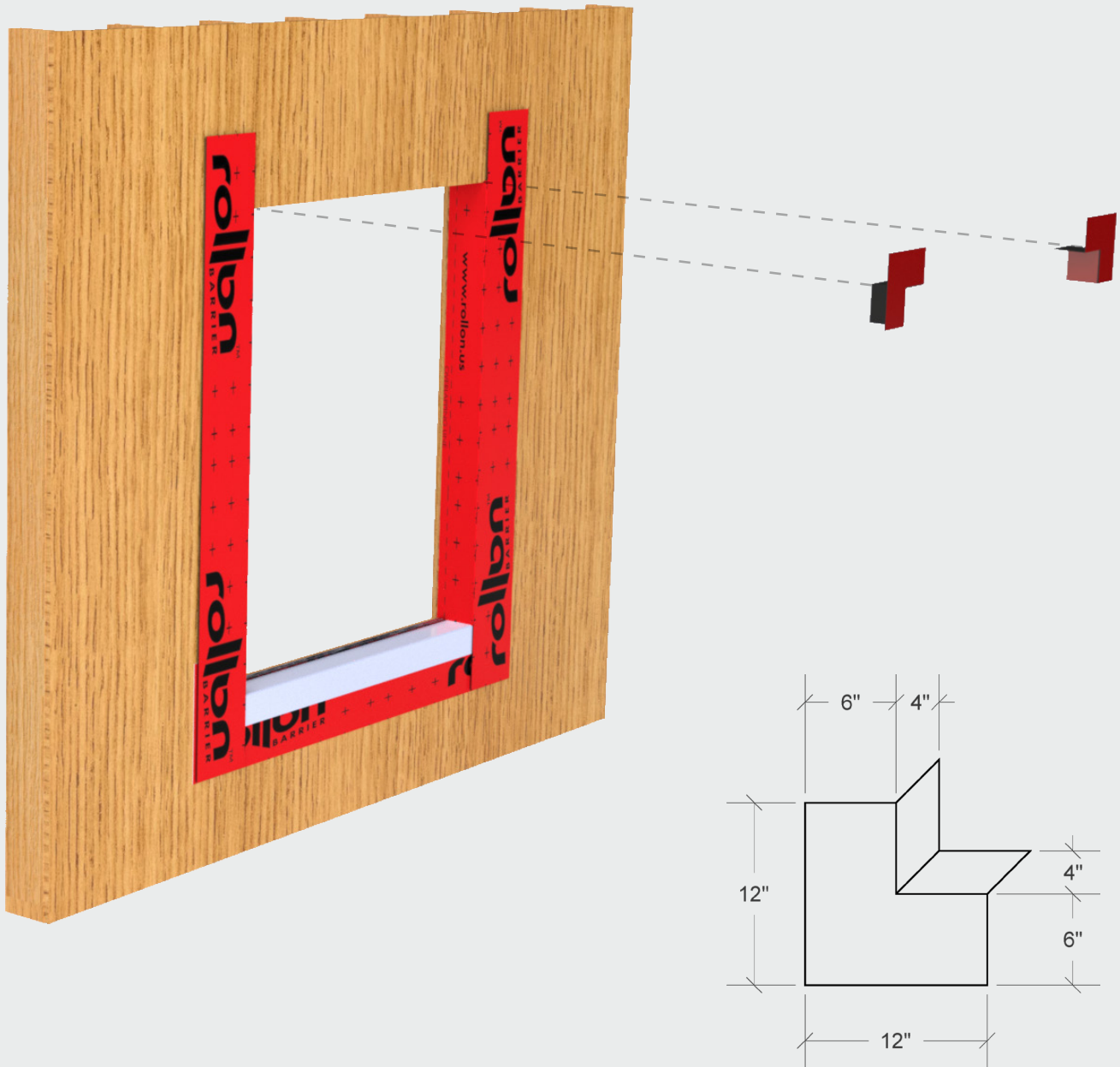

STEP 6

Apply **rollon**[™] head liner to head or R.O. wrap into R.O.
 Apply sealant at all seams.
 Apply sealant 1" from the edge and use putty knife to spread the sealant under membrane.

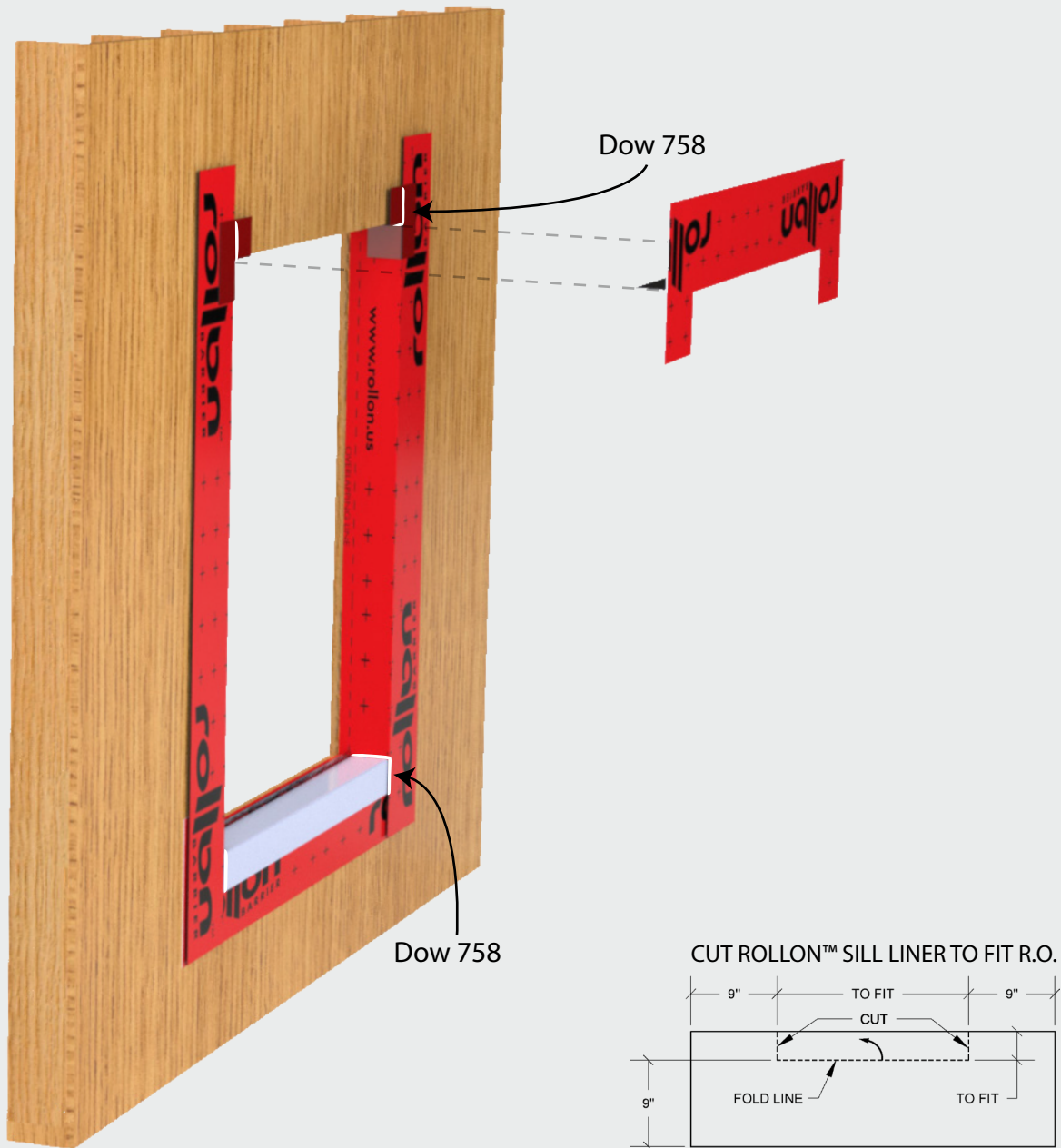

STEP 7

Fasten window per MFR requirements.

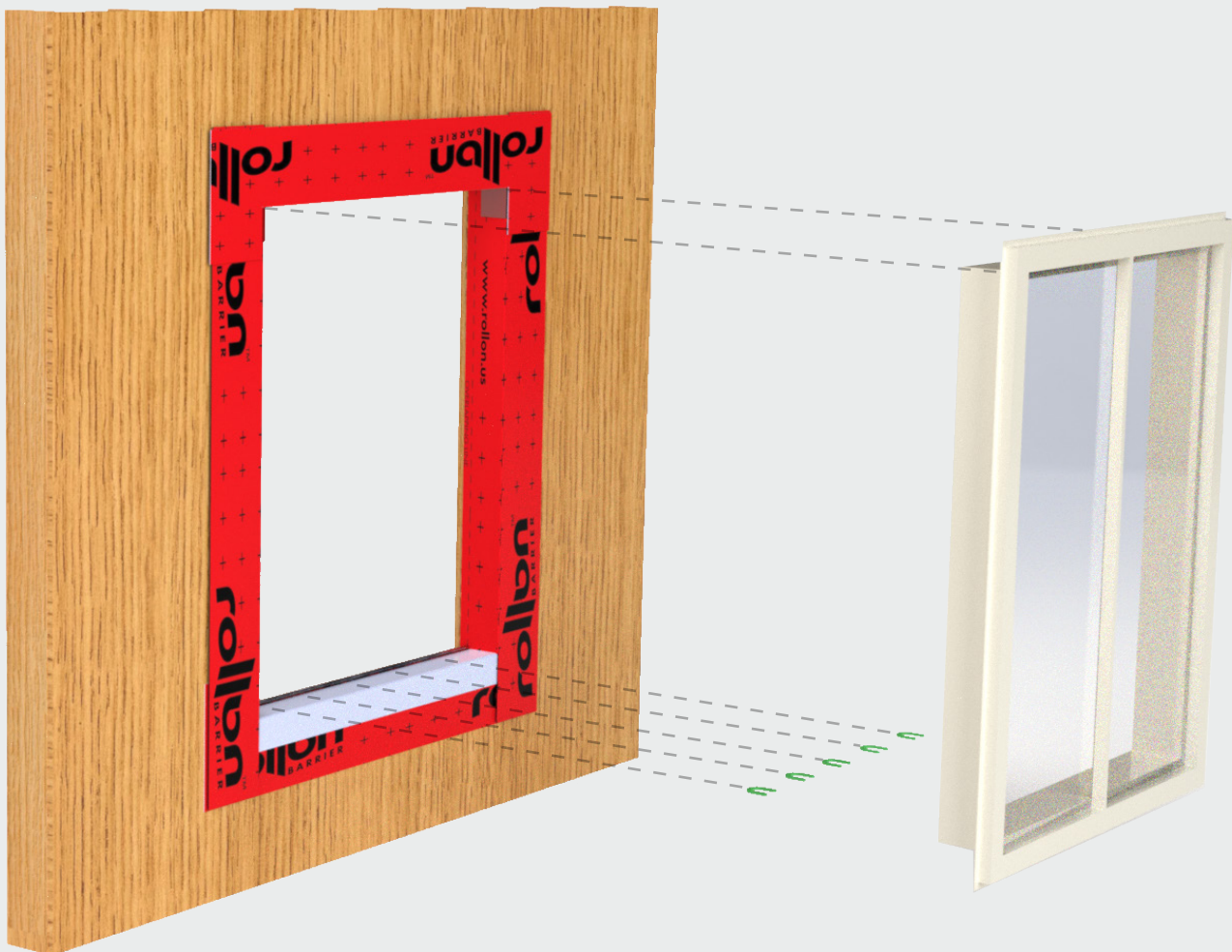

STEP 8

NOTES:

1. See window plan and sections for interior rod and sealant install.
2. See window plan and sections for trim flashing (if occurs).
3. *Ensure continuous contact w/sealant at up stand.

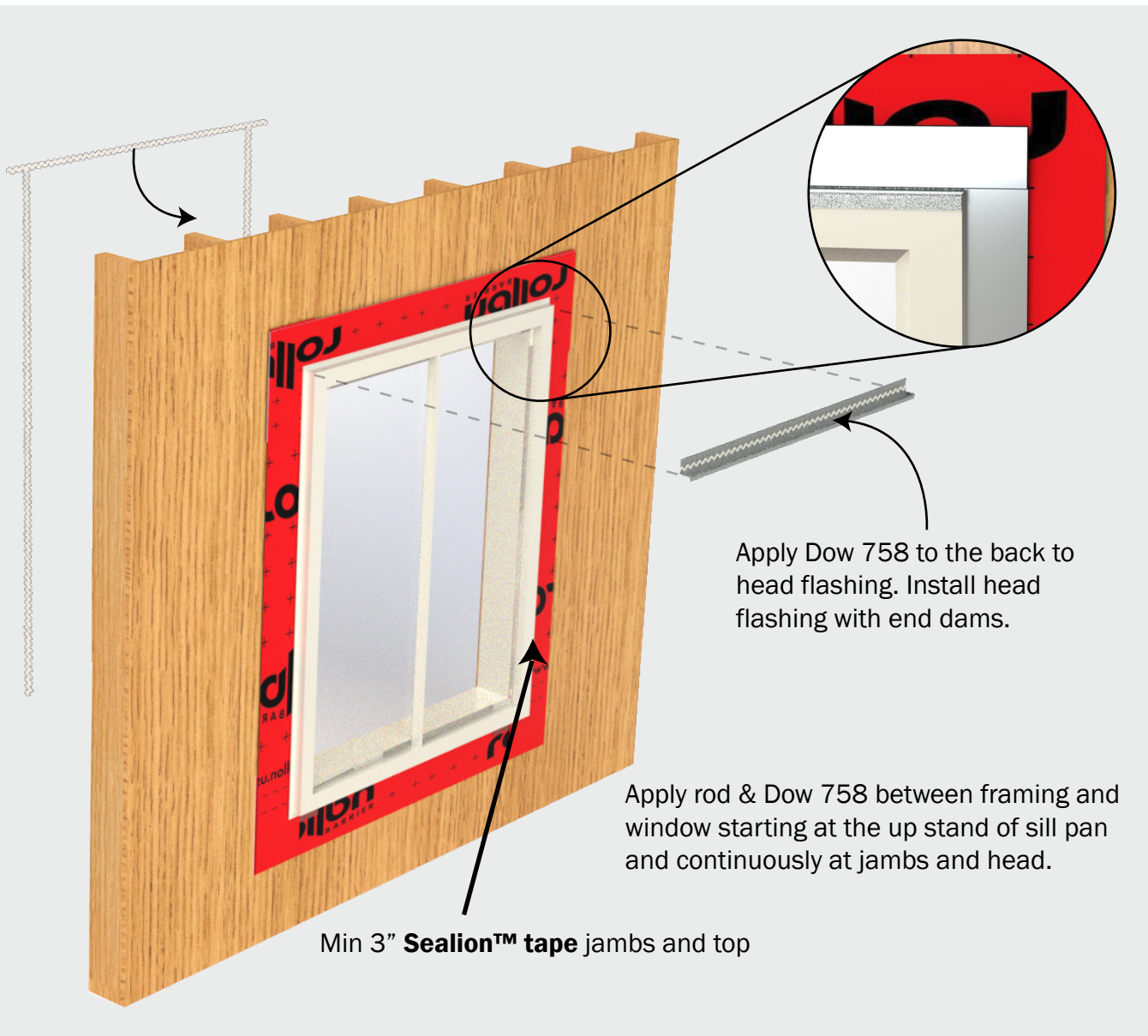

STEP 9

Apply primary **rollon**TM to structure, tucking under **rollon**TM sill liner.



STEP 10

Apply primary **rollon**TM on top of **rollon**TM sill liner.



STEP 11

NOTES:

1. At exterior: apply rod & Dow 758 between window frame and siding.
2. At interior: apply rod & Dow 758 between framing and window starting at the up stand of sill pan and continuously at jambs and head.
3. Apply Dow 758 to all seams for air barrier.



Continue applying primary **rollon™** to structure with min 6" horizontal lap and 12" vertical lap. Use sealant Dow 758 for all loose edges of primary **rollon™**.

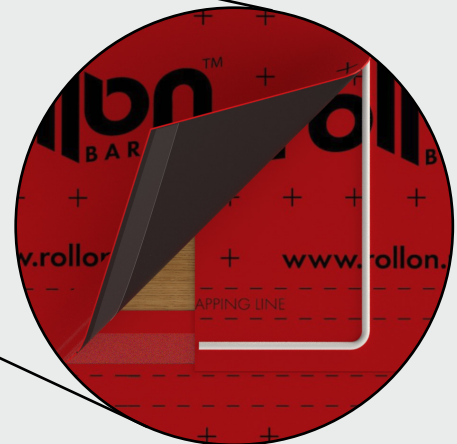

STEP 12

Fastening **rollon™ cap** ratio:

Horizontally: every second stud

Vertically: 30" o.c.

Depth into stud: 1" - wood stud, 1/2" - metal stud

Screw bugle: #8

