

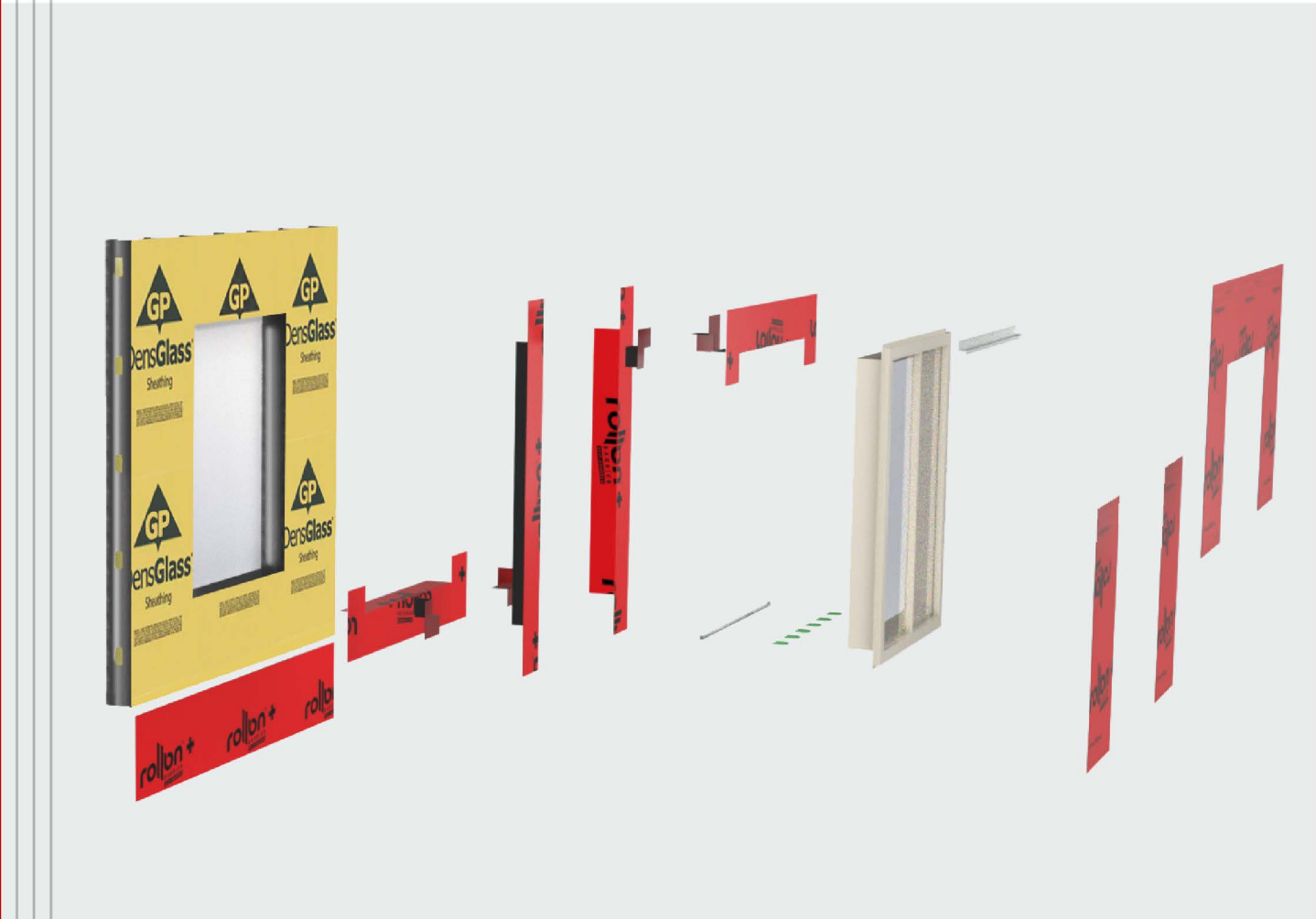

Self Adhered Membrane

WINDOW DETAILS -- Liquid Applied Flashing



STEP 1

Apply rollon™+ sill liner to sill of R.O. by removing the release liner from the top 6 inches. Leave the bottom of the rollon™+ liner loose to allow the primary rollon™+ to be inserted underneath.



STEP 3

Apply rollon™+ jamb liner to the jamb of the rough opening. Lap base over sill liner.

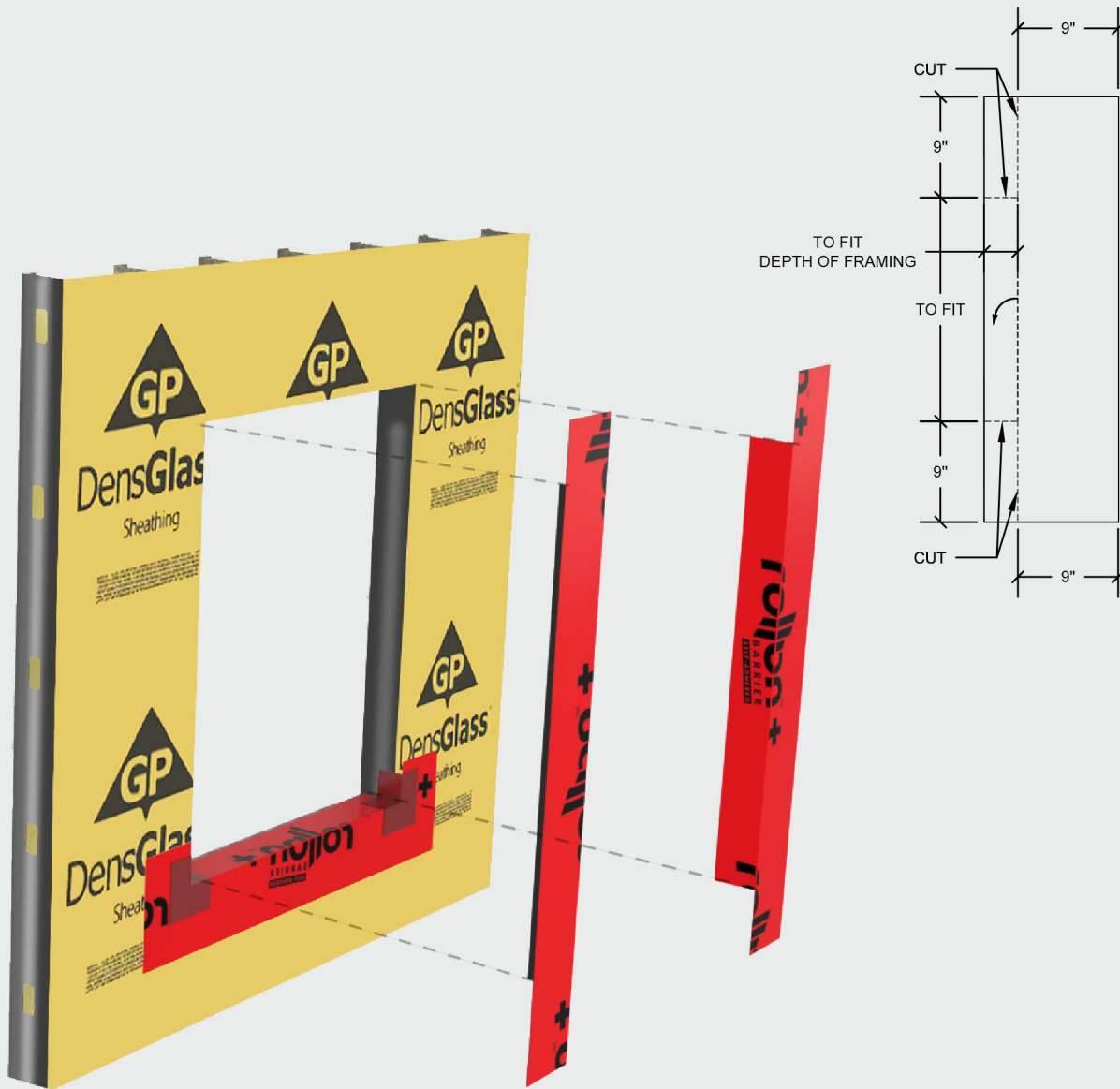

STEP 4

Apply rollon™ Corner to sill jump of R.O. over sill liner.

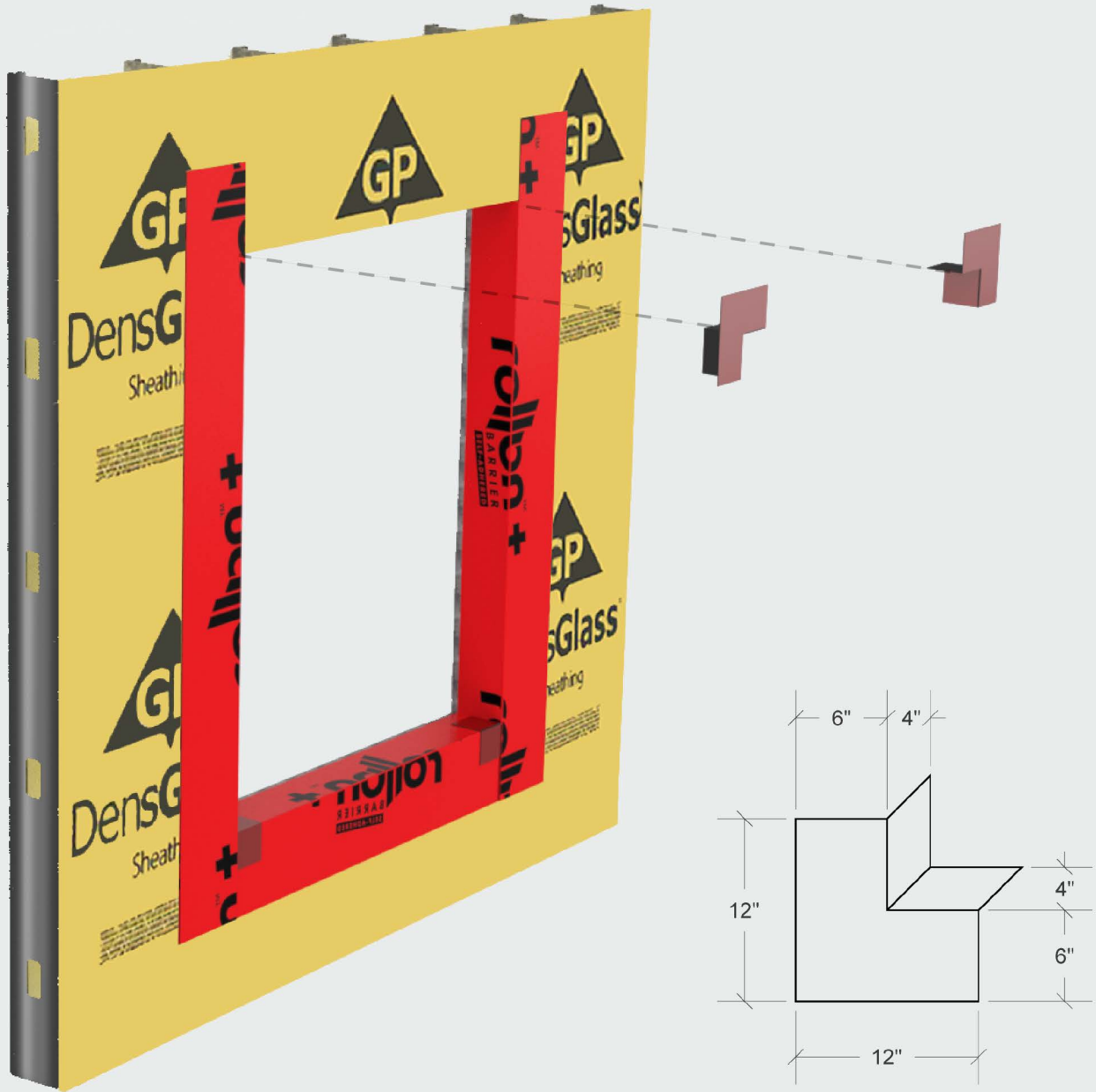

STEP 5

Apply rollon™+ head liner to head or R.O.

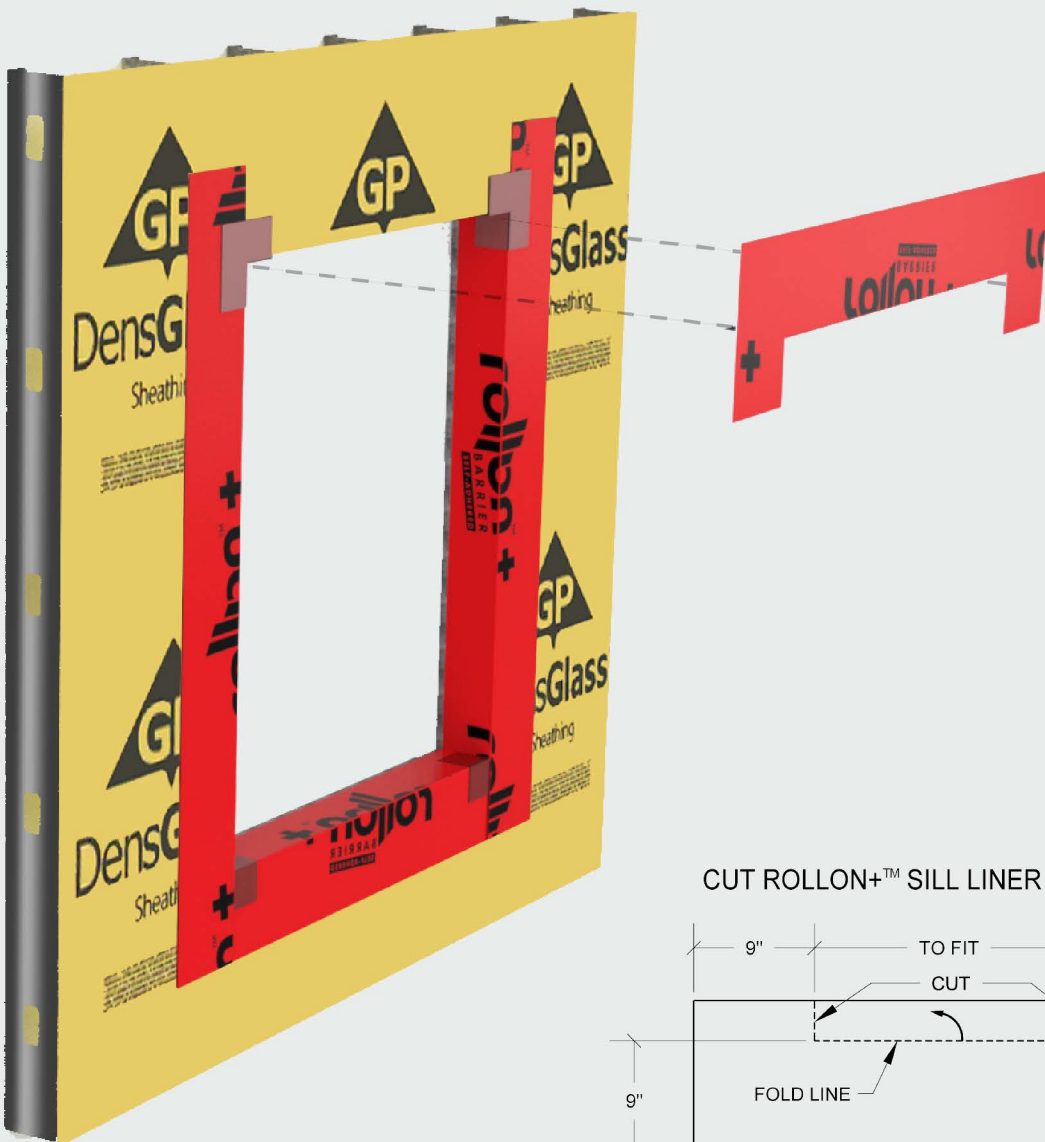

STEP 6

Install L-angle in R.O., embed in liquid applied flashing Sealion™ LAF.

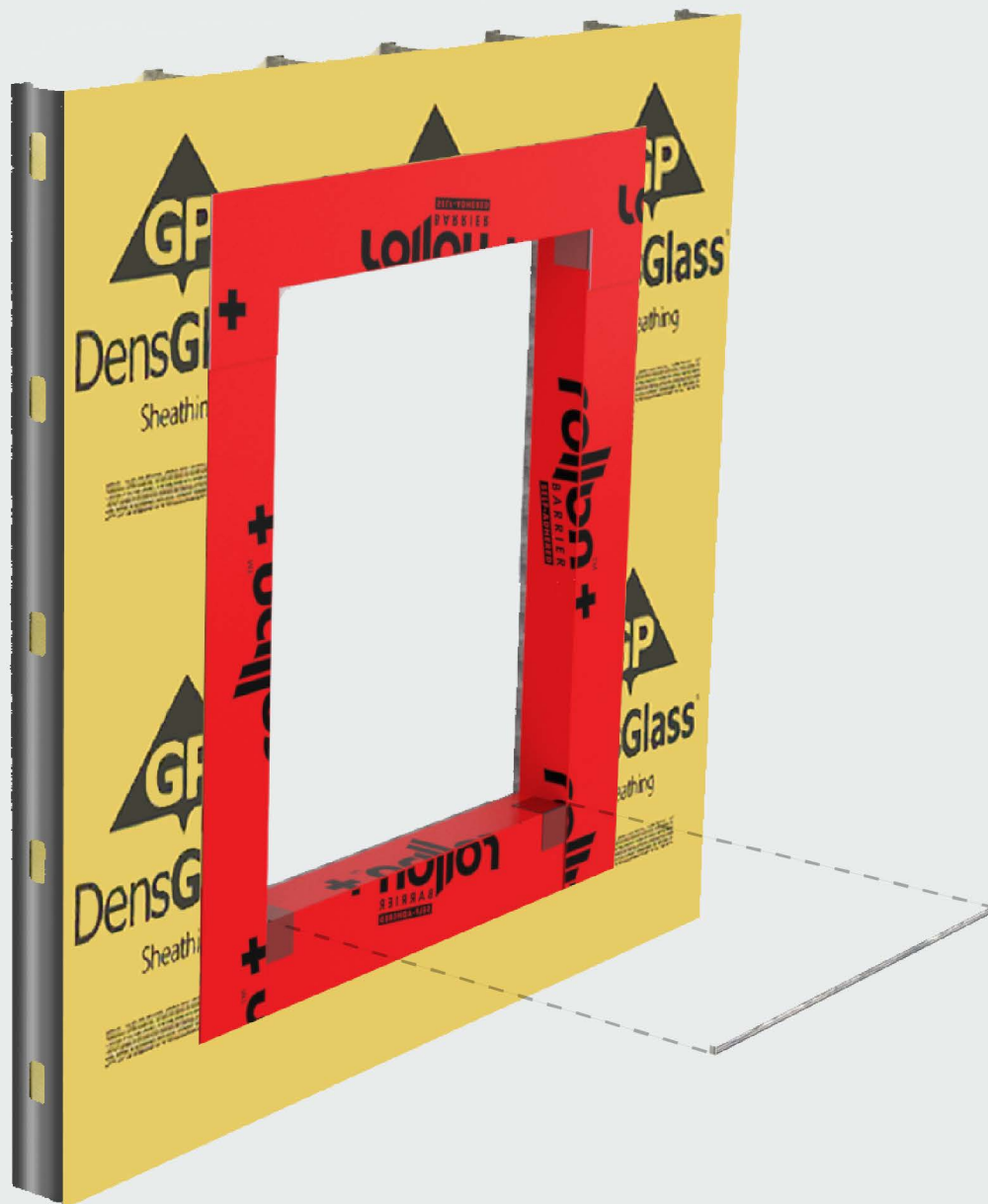

STEP 7

Apply Sealion™ LAF membrane in a zig-zag pattern. Immediately spread the flashing membrane with a putty knife.

Window width + ½" (inner face)
 Window flange + ½" (outer face)

Apply Sealion LAF™ membrane in a zigzag pattern. Immediately spread flashing membrane with putty knife.

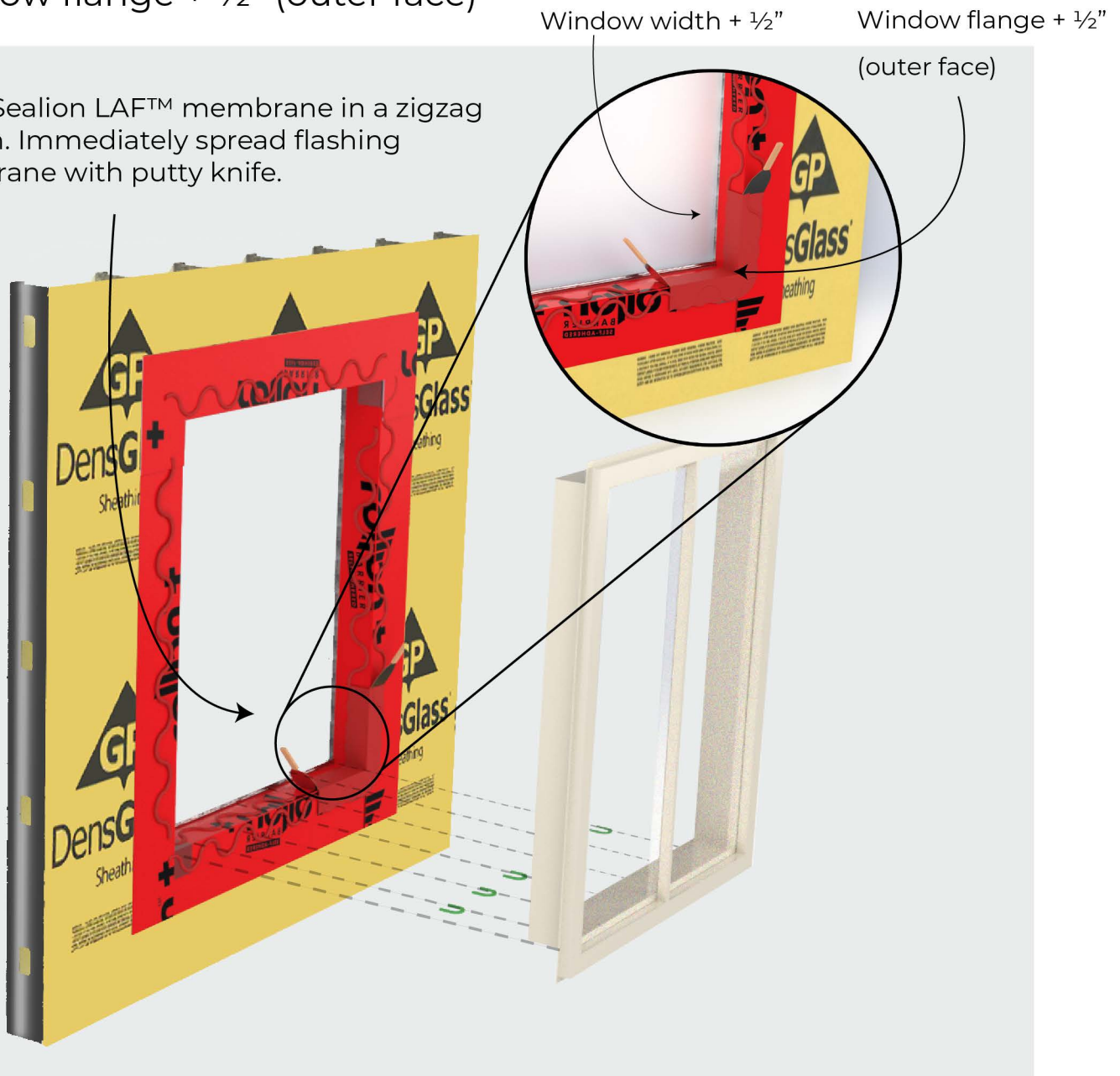

STEP 8

Install 1/8" shims on top of sill. Fasten window per MFR requirements.

Note: See window plan for interior rod and sealant install

Apply SealionTM LAF on window flange + 2".

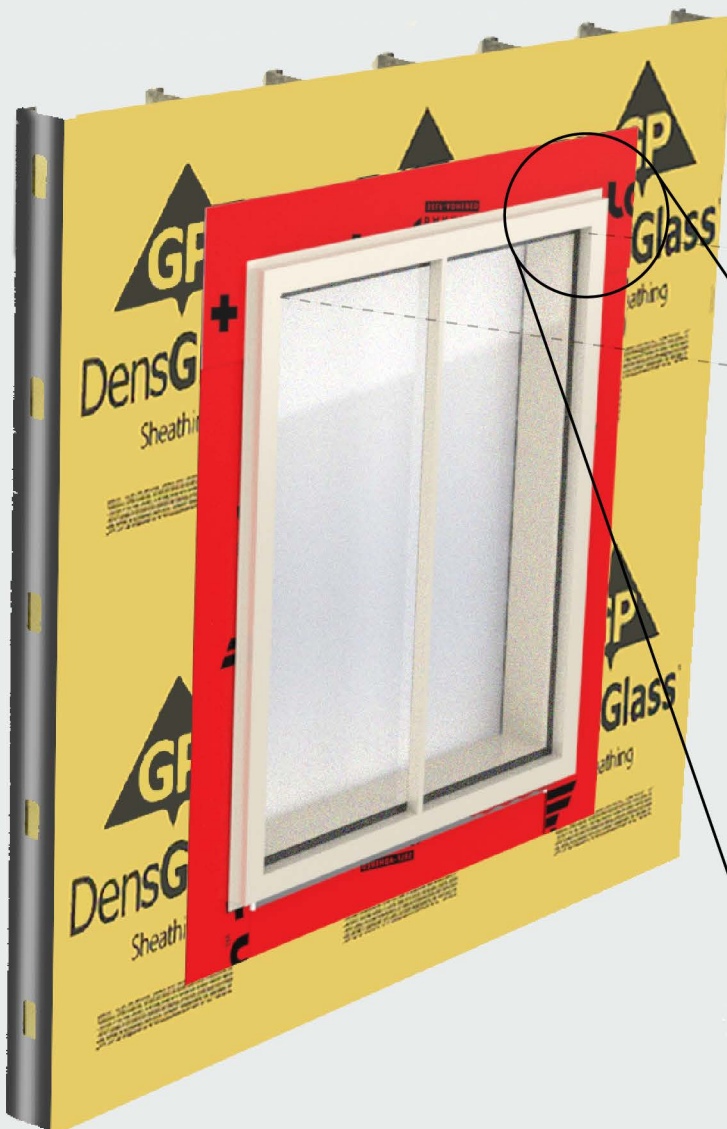

Apply rod & Dow 758 between framing and window starting at the upstand* of sill pan and continuously at jambs and head.

Apply Dow 758 to the back to head flashing. Install head flashing with end dams.

Apply Sealion LAF on window flange + 2"

STEP 9

Apply primary rollon™+ to structure, tucking under rollon™+ sill liner. Remove release paper and ensure full adhesion of rollon™+ sill liner to primary rollon™+ for air barrier.



STEP 10

Apply primary rollon™ +. Overlap: 6" horizontally,
12" vertically

